

- |                   |                      |                             |                        |
|-------------------|----------------------|-----------------------------|------------------------|
| <b>TOOL LIST</b>  |                      |                             |                        |
| 1 - LEVEL         | 10 - COLD CHISELS    | 19 - BRACE                  | 28 - WRECKING BAR      |
| 2 - MALLET        | 11 - RULES           | 20 - TACK HAMMER            | 29 - HACK SAW          |
| 3 - STEEL SQUARE  | 12 - PLIERS          | 21 - MACHINIST HAMMER       | 30 - BLADES (HACK SAW) |
| 4 - TRY-SQUARE    | 13 - LEATHER PUNCH   | 22 - FIVE POUND HAMMER      | 31 - TIN SNIPS         |
| 5 - BLOCK PLANE   | 14 - ELECTRIC PLIERS | 23 - CLAW HAMMER            | 32 - FILE CLEANER      |
| 6 - JACK PLANE    | 15 - WOOD CHISELS    | 24 - HATCHET                | 33 - FILES             |
| 7 - SCREW DRIVERS | 16 - AUTOMATIC DRILL | 25 - COMPASS SAW            | 34 - CRESCENT WRENCHES |
| 8 - DRIFT PUNCHES | 17 - AUGER BITS      | 26 - SAWS (CROSS CUT & RIP) | 35 - END WRENCHES      |
| 9 - CENTER PUNCH  | 18 - NAIL SETS       | 27 - PIPE WRENCHES          | 36 - OIL STONE         |
|                   |                      |                             | 37 - OIL CAN           |

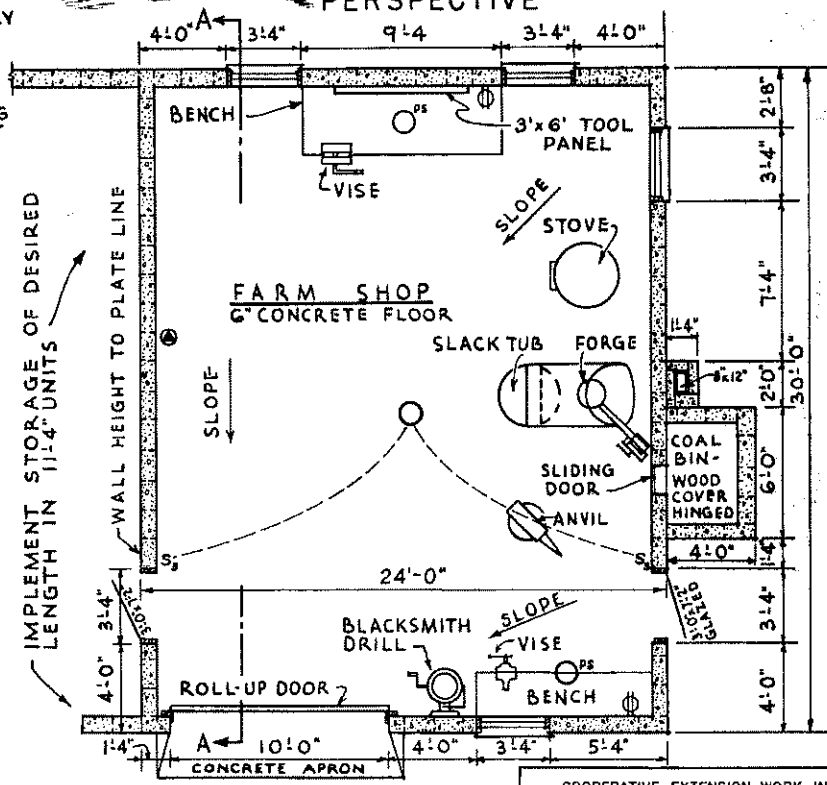

COOPERATIVE EXTENSION WORK IN  
AGRICULTURE AND HOME ECONOMICS  
STATE OF NORTH DAKOTA  
NORTH DAKOTA AGRICULTURAL COLLEGE  
AND  
UNITED STATES DEPARTMENT OF AGRICULTURE COOPERATING

**CONCRETE MASONRY  
FARM SHOP FOR MACHINERY SHED**

N.J.      EX. 5678      SHEET 1 OF 1