

AE1594 (Reviewed April 2023)

Preparing Flood-damaged Homes for Winter

Kenneth Hellevang, Ph.D., P.E.
NDSU Extension

If you do not plan to rebuild your flood-damaged home until next year, you must prepare it for winter.

Ice layers can form in the ground when the frost line is near the ground water table, causing the soil to lift. This is known as frost heaving. It can lift the foundation and basement floor and walls, damaging them and other parts of the structure. Frost heaving is more likely if the water table is high and the soil is a clay or silt instead of well-drained gravel.

Also, very wet soils will expand when water in the soil freezes. This can push basement walls laterally enough to crack them and damage the home's structure. Again, this is more likely in low-porosity soils, such as clay or silt, and may be more of a concern with concrete block walls than poured concrete walls.

Insulate and Heat

Insulate the basement ceiling and place insulation on the exterior of the basement walls to reduce the potential for frost heaving. Polystyrene or other closed-cell insulation works well for exterior insulation.

Soil provides little insulation, so placing insulation on the exterior of the house next to the basement wall is important. Snow is an excellent insulation, so piling it near the house is another option.

However, insulation alone may not be adequate to prevent frost heaving in an unheated home, so add heat to keep the temperature in the basement above freezing. The more

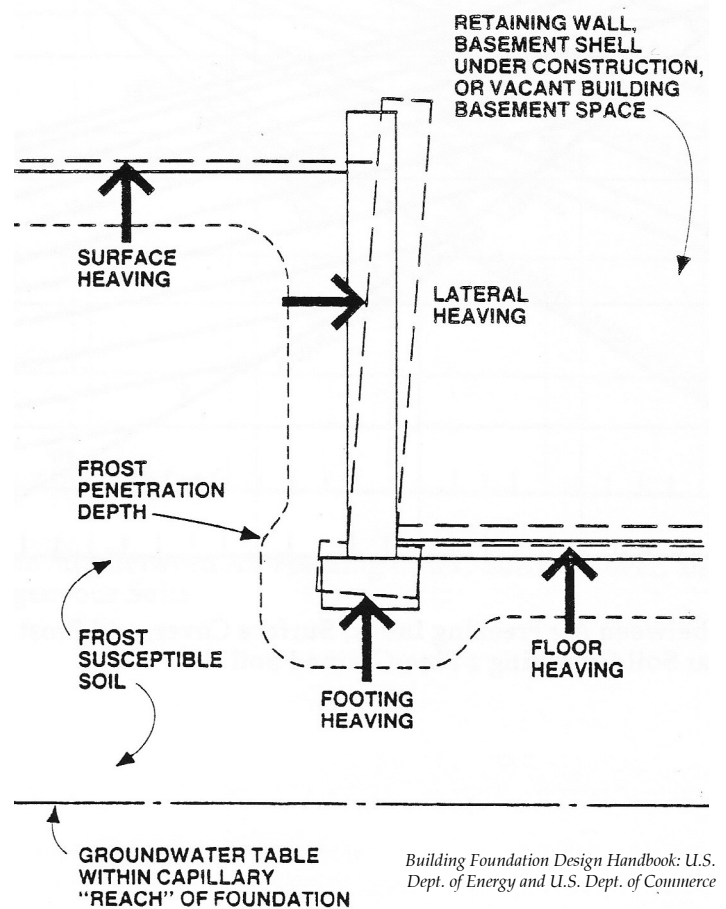
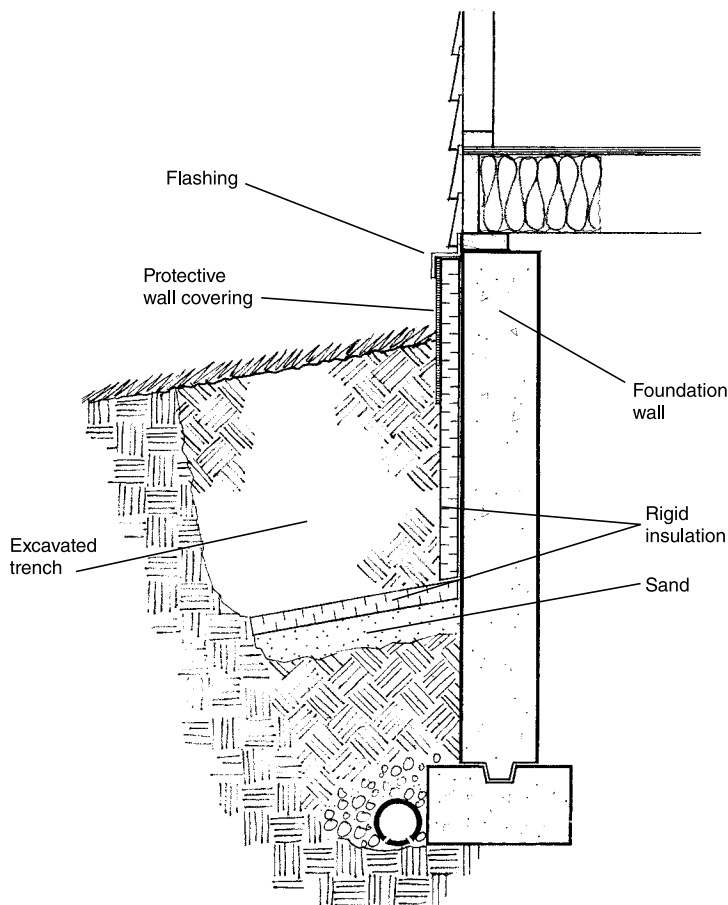

Photo by Carl Pedersen, NDSU

NDSU

EXTENSION

North Dakota State University
Fargo, North Dakota



Home Energy Guide Techniques Tactics and Tips:
Minnesota Dept. of Commerce Energy Information Center

insulation you use, the less heat you'll need. (Note: Insulating the inside of the basement walls reduces heat flow to the walls and may increase the potential for frost heaving under the foundation.)

A vented heater that discharges moisture vapor and other combustion products outdoors is a good heat source. A nonvented space heater will produce about ½ gallon of water for each gallon of fuel burned, which will release a large amount of moisture into the heated space. A warm, moist environment could lead to the development of mold.

Carbon monoxide is a concern with combustion heaters, so place a carbon monoxide detector in the heated space.

Also place a vapor retarder (polyethylene sheet) on the warm side of the insulation inside the house to limit the amount of moisture that may move through the insulation and condense on the cold surface behind the insulation. This condensation can lead to mold growth and structural damage.

Reduce Soil Moisture

One way to limit the potential for frost heaving is to make sure the soil contains little moisture. To do that, have granular fill along the basement walls and footing as well as under the basement floor, then use drain tile and a pump to remove the water from the granular material.

Remove Moisture From the Home

Moisture vapor from the wet soil will continue to come through the basement walls and floor, creating a damp environment, so provide air exchange, such as by opening basement windows for a short time, to remove the moisture. Many dehumidifiers will not operate properly at temperatures near freezing, so using one may not be feasible.

Protect Water Pipes, Sewer Drains

Frost may freeze water in water lines under the floor or near the basement wall, causing the pipes to rupture. Water also can freeze in water lines in an unheated basement, so keep the temperature in the basement above freezing.

Another option is to shut the water off at the street and drain the water from the water line or add antifreeze made for water pipes to the water line.

Also fill sewer drain water traps, the U-shaped pipes that keep sewer gas from entering the home, with RV antifreeze to keep the water from freezing and damaging the pipe.

Exterior Sheathing

Attach sheathing on all corners of a house if the exterior sheathing has been removed, or use another method of providing lateral bracing. Exterior sheathing is important because it provides structural strength for the structure. Studs provide vertical but not lateral strength.

Keep Snow Out

Do not allow snow to melt inside the house. Each 10 inches of snow can hold about an inch of water. Wrap the house in plastic to keep the snow out, and remove any snow that enters the house.

For more information on this and other topics, see www.ag.ndsu.edu

NDSU encourages you to use and share this content, but please do so under the conditions of our Creative Commons license. You may copy, distribute, transmit and adapt this work as long as you give full attribution, don't use the work for commercial purposes and share your resulting work similarly. For more information, visit www.ag.ndsu.edu/agcomm/creative-commons.

County commissions, North Dakota State University and U.S. Department of Agriculture cooperating. NDSU does not discriminate in its programs and activities on the basis of age, color, gender expression/identity, genetic information, marital status, national origin, participation in lawful off-campus activity, physical or mental disability, pregnancy, public assistance status, race, religion, sex, sexual orientation, spousal relationship to current employee, or veteran status, as applicable. Direct inquiries to Vice Provost for Title IX/ADA Coordinator, Old Main 201, NDSU Main Campus, 701-231-7708, ndsuoaa@ndsu.edu. This publication will be made available in alternative formats for people with disabilities upon request, 701-231-7881.