

## The next generation in scanning excellence

# fi-8170 Document Scanner

Made for demanding workflows, the compact fi-8170 scanner gives small and large organizations unparalleled productivity. Patented feeding technologies, industry leading reliability, and proprietary Clear Image Capture (CIC) technology deliver the highest quality digital images to meet the needs of organizations on their digital transformation journey.



### Image Quality

Clear Image Capture (CIC) technology resets the benchmark for high quality image capture, by combining the reliability and flexibility of Contact Imaging Sensor (CIS) hardware, with an industry-leading, image processor. CIC technology delivers precise, crisp images, and industry-leading OCR accuracy rates while also removing unwanted watermarks and artifacts.

### Paper Feeding

Evolved paper handling with a large 100-page hopper, an all-wheel drive mechanism, and fast 140 images captured per minute, make the fi-8170 one of the easiest and most efficient scanners to operate. The patented Automatic Separation Control uses state of the art technology to sense paper weights and adjusts to consistently separate documents and provide the perfect feed, ensuring documents are safely captured.

### Reliability

The fi-8170 is built to last and powers up every time you need it regardless of job size. Strong urethane rollers, heavy duty motors, a sturdy frame, and durable consumables combine for a long-lasting scanner that will let your organization capture the volumes of paper from seasonal peaks and heavy backlogs, worry free. Backed by US-based, legendary solutions architects and support teams.



#### PaperStream IP

Compatible with all major document management software packages, PaperStream IP (PSIP) is a TWAIN/ISIS® compliant driver that cleans up and optimizes scanned images without any configuration.

#### PaperStream Capture

Take advantage of powerful indexing and sorting features, putting the document in the right location for great organization and fast retrieval. Now includes both 2D and 1D barcode support in the box.

#### PaperStream Clickscan

Easy to use capture software for any business. Simple scanning interface with 3-steps: scan, select destination, and save.

#### Flexible connectivity options

Choose between PaperStream IP Net for flexible, adaptable capture architectures, and PaperStream NX Manager for centralized, server-based capture.

# The next generation in scanning excellence

## Ricoh fi-8170 Document Scanner

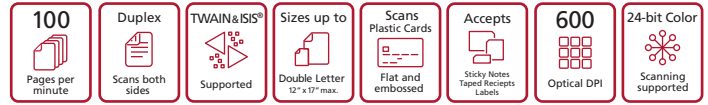

Technical Information	
<b>Scanner Type</b>	ADF (Automatic Document Feeder) / Manual Feed, Duplex
<b>Scanning Speed*1</b> (A4 Portrait) (Color / Grayscale*2 / Monochrome*3)	Simplex: 70 ppm (200/300 dpi) Duplex: 140 ipm (200/300 dpi)
<b>Image Sensor Type</b>	CIS x 2 (front x 1, back x 1)
<b>Light Source</b>	RGB LED x 2 (front x 1, back x 1)
<b>Optical Resolution</b>	600 dpi
<b>Output Resolution*4</b> (Color / Grayscale / Monochrome)	50 to 600 dpi (adjustable by 1 dpi increments) 1,200 dpi (driver)*5
<b>Output Format</b>	Color: 24-bit, Grayscale: 8-bit, Monochrome: 1-bit
<b>Background Colors</b>	White/Black (selectable)
<b>Document Size</b>	
Maximum*6	8.5 x 14 in. (215.9 x 355.6 mm)
Minimum	1.9 x 2 in. (48x50 mm)
Long Page Scanning*7	240 in. (6,096 mm)
<b>Paper Weight (Thickness)</b>	
Paper	5.3 to 124 lb (20 to 465 g/m <sup>2</sup> )*8
Booklet	0.276 in. (Less than 7 mm)*9
Plastic Card	0.055 in. (1.4 mm) or less*10
<b>ADF Capacity*11 *12</b>	100 sheets (Letter 20 lb or A4 80 g/m <sup>2</sup> )
<b>Expected Daily Volume*13</b>	10,000 sheets
<b>Multifeed Detection</b>	Overlap detection (Ultrasonic sensor) Length detection
<b>Paper Protection</b>	Image monitoring, Sound detection (iSOP)*14
<b>Interface</b>	
USB	3.2 Gen 1x1 / USB 2.0 / USB 1.1
Ethernet	10BASE-T, 100BASE-TX, 1000BASE-T
<b>Power Requirements</b>	AC 100 to 240 V 50/60Hz
<b>Power Consumption</b>	
Operating Mode	28 W or less / 17 W (Eco mode)
Sleep Mode	2.0 W or less (LAN) / 1.4 W or less (USB)
Auto Standby (Off) Mode	0.2 W or less
<b>Operating Environment</b>	
Temperature	41 to 95 °F (5 to 35 °C)
Relative Humidity	15 to 80% (non-condensing)
<b>Environmental Compliance</b>	ENERGY STAR®, RoHS
<b>Dimensions*15</b> (Width x Depth x Height)	11.8 x 6.7 x 6.4 in. (300 x 170 x 163 mm)
<b>Weight</b>	8.8 lb (4 kg)
<b>Supported Operating System</b>	Windows® 11, Windows® 10, Windows® 8.1, Windows® 7, Windows Server® 2022, Windows Server® 2019, Windows Server® 2016, Windows Server® 2012 R2, Windows Server® 2012, Windows Server® 2008 R2, macOS, Linux (Ubuntu)
<b>Included Software / Drivers</b>	PaperStream IP Driver (TWAIN/TWAIN x64/ISIS), WIA Driver*16, Image Scanner Driver for macOS (ICA)*17*17, Image Scanner Driver for Linux (SANE)*17*17, PaperStream Capture, PaperStream ClickScan*17, Software Operation Panel, Error Recovery Guide, ABBYY FineReader for ScanSnap™*17, Scanner Central Admin
<b>Image Processing Functions</b>	Multi image output, Automatic color detection, Blank page detection, Dynamic threshold (iDTC), Advanced DTC, SDTC, Error diffusion, Dither, De-Screen, Emphasis, Dropout color (None/Red/Green/Blue/White/Saturation/Custom), sRGB output, Hole punch removal, Index tab cropping, Split image, De-Skew, Edge filler, Vertical streaks reduction, Background pattern removal, Cropping, Static threshold.
<b>Included Items</b>	ADF paper chute, AC cable, AC adapter, USB cable, Setup DVD-ROM
<b>Trade Compliant*18</b>	PN: PA03810-B075
<b>Standard Model</b>	PN: PA03810-B055
<b>Certifications</b>	Kofax® VRS Elite
<b>Warranty</b>	1 Year Advance Exchange

Service Programs & Options			
<b>Advance Exchange</b>	S8170-AEMYNBD-1 S8170-AEMYNBD-3 S8170-AEMYNBD-5	One, three or five year programs offer whole-unit, next business day replacement for scanner equipment*	<b>Industry-leading support keeps digital transformation projects on-time and on budget</b> <ul style="list-style-type: none"> <li>• U.S. based support</li> <li>• Specialized Teams</li> <li>• Flexible service programs</li> </ul>
<b>Depot Mail-in Repair</b>	S8170-DEPW5DY-3	3-year scanner contract provides mail-in unit repair that includes spare parts, labor, and one-way shipping to customer	
<b>PaperStream Capture Pro Deluxe Bundle</b>	PSCP-WG-0001	PaperStream Capture Pro Low-Volume software license	
<b>Premium Bundle</b>	CG01000-303001 CG01000-303101	Deluxe Bundle Scanner bundled with PaperStream Capture Pro Scanner bundled with 3 years additional Advance Exchange service	

Consumables and Options		
<b>Imprinter (Post)</b>	PA03710-D401	User installable. Prints a string of characters on the back of document after scan.
<b>Print Cartridge for fi-8170</b>	CA00050-0262	Lifetime: approx. 4,000,000 printed characters
<b>Brake Roller</b>	PA03810-0001	Lifetime: approx. 200,000 sheets or 1 year
<b>Pick Roller</b>	PA03670-0002	Lifetime: approx. 200,000 sheets or 1 year
<b>ScanAid Kit</b>	CG01000-302801	Consumable kit with instructions and cleaning supplies
<b>Carrier Sheets</b>	PA03360-0013	Pack of 5 Sheets
<b>Photo Carrier Sheets</b>	PA03770-0015	Pack of 3 Sheets
<b>Booklet Carrier Sheet</b>	PA03810-0020	Pack of 1 Sheet



\*1 Actual scanning speeds may vary with data transmission and software processing times. \*2 Indicated speeds are from using JPEG compression. \*3 Indicated speeds are from using TIFF CCITT Group 4 compression. \*4 Selectable maximum resolution may vary depending on the length of the scanned document. \*5 Limitations may apply to the size of documents that can be scanned, depending on system environment, when scanning at high resolution (over 600 dpi). \*6 Maximum document width possible for scanning is 9.5 in. (240 mm). \*7 For use with PaperStream NX Manager, the maximum resolution supported is 400 dpi, with maximum lengths ranging with resolution. Simplex: 72 in. (1,828.8 mm) [below 300 dpi], 14 in. (355.6 mm) [below 400 dpi]. Duplex: 34 in. (863.6 mm) [below 300 dpi], 14 in. (355.6 mm) [below 400 dpi]. \*8 Thicknesses of up to 34 to 56 lb (128 to 209 g/m<sup>2</sup>) can be scanned for A8 (2.1 x 2.9 in. / 52 x 74 mm) sizes. \*9 Indicated thickness is inclusive of Booklet Carrier Sheet thickness when using the Carrier Sheets. \*10 Continuous feeding is supported when scanning up to 10 unembossed cards with thicknesses of 0.76 mm or less. \*11 Maximum capacity depends on paper weight and may vary. \*12 Capable of setting additional documents while scanning. \*13 Numbers are calculated using scanning speeds and typical hours of scanner use, and are not meant to guarantee daily volume or unit durability. \*14 Intelligent Sonic Paper Protection. \*15 Excludes the ADF paper chute and stacker. \*16 Functions equivalent to those offered by PaperStream IP may not be available with the Image Scanner Driver for macOS/Linux or WIA Driver. \*17 Refer to the fi Series Support Site for driver/software downloads and full lineup of all supported operating system versions. [www.pfu-us.ricoh.com](http://www.pfu-us.ricoh.com). \*18 EPEAT is Gold.

\*Replacement units shipped overnight for all requests received by 2 P.M. PST, Monday-Friday

### Trademarks

ISIS is a trademark of Open Text. Microsoft, Windows, and Windows Server are either registered trademarks or trademarks of Microsoft Corporation in the United States and/or other countries. macOS is a trademark of Apple Inc., registered in the U.S. and other countries. Linux is the registered trademark of Linus Torvalds in the U.S. and other countries. Any other products or company names appearing in this document are the trademarks or registered trademarks of the respective companies.

### Safety Precautions

Please carefully read the safety precautions prior to the use of this device and follow the recommended instructions for correct use. Do not place this device in wet, moist, highly humid, dusty or oily areas. Use of this device under such conditions may result in electrical shock, fire or damage to the device. Please use this device within the power ratings listed.

### ENERGY STAR®

PFU Limited, a Ricoh company, has determined that this product meets the ENERGY STAR® guidelines for energy efficiency. ENERGY STAR® is a registered trademark of the United States. Specifications are subject to change without notice.

Specifications are subject to change without notice. Visit the fi Series website for more information. [www.pfu-us.ricoh.com](http://www.pfu-us.ricoh.com)



To learn more, visit us at [www.RicohDocumentScanners.com](http://www.RicohDocumentScanners.com) or contact us at (888) 425-8228.

Copyright © 2023 PFU America, Inc. All other trademarks are the property of their respective owners.

V1\_fi8170\_082123